

woodworkers

To site adjust multi-fold doors

BEFORE ADJUSTMENT ENSURE ALL TIMBER SURFACES HAVE BEEN SEALED CORRECTLY, TAKING PARTICULAR CARE THAT ALL END GRAIN (STILES ON DOORS) HAS AT LEAST TWO COATS OF SEALER TO MINIMIZE TIMBER MOVEMENT DUE TO VARYING CLIMATIC CONDITIONS. (ALL WOODWORKERS JOINERY MUST BE SEALED WITHIN 48 HOURS OF DELIVERY).

1. Doors need to be raised or lowered.

- Remove all the "locking devices" located at the top of all the hangers and pivot (just under the rollers), by removing the phillips head screw (this is a short screw, be very careful not to loose it).
- Before raising the door firstly check the bottom pivot to ensure it has sufficient tolerance above the hinge leaf to move upwards. The tolerance can be increase by turning the main pivot shaft with an allen key anti-clockwise.
- To raise the door use an allen key to turn the bottom end of the main shaft of the top hanger or pivot clockwise, to lower the door turn it anti-clockwise,

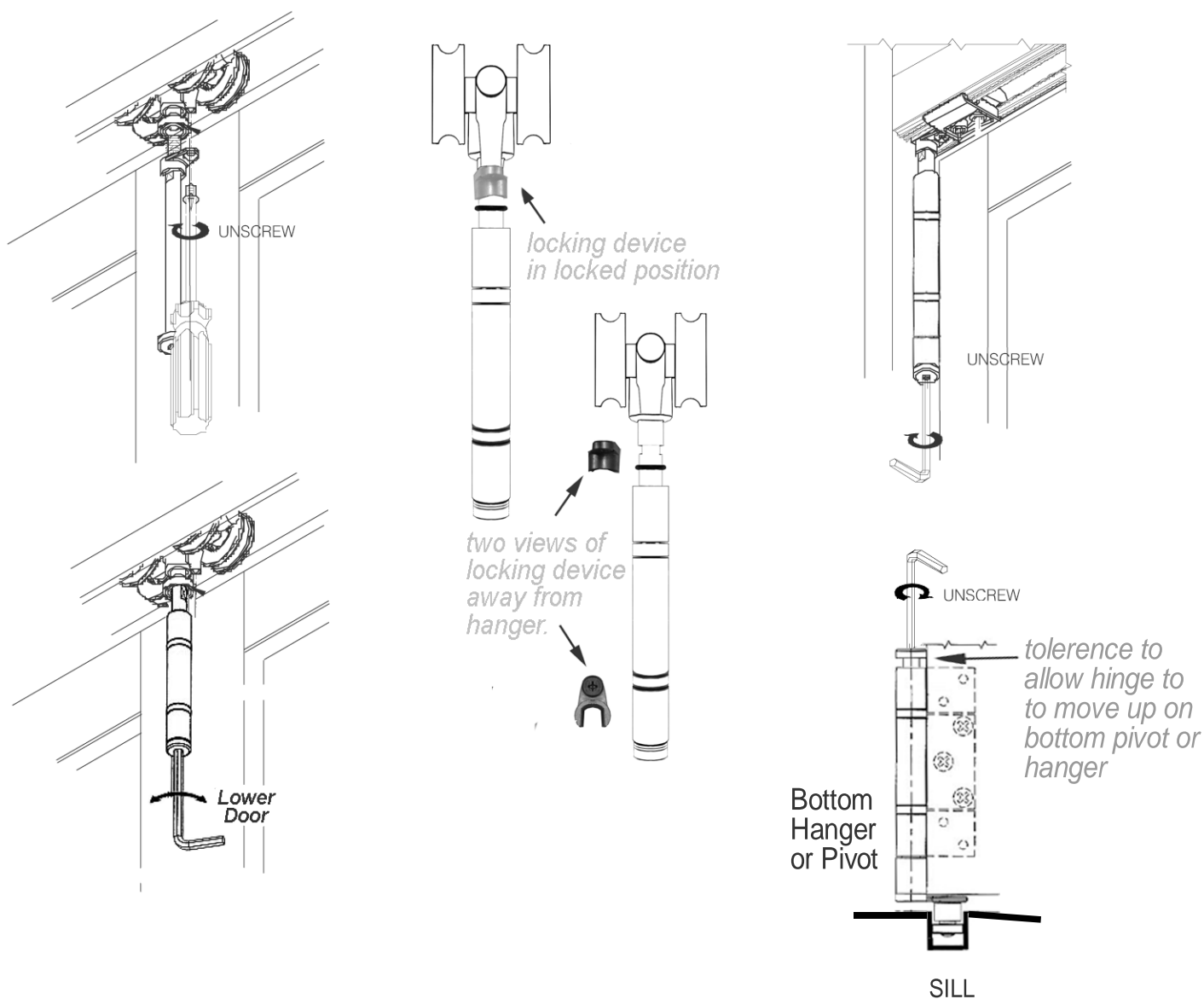

woodworkers

To site adjust multi-fold doors

2. Closing to tight.

Decrease the gap between the pivot hanger and the jamb to overcome a tight "spring" when pulling shut and securing the flush bolts.

- Loosen the two allen head screws at the top of the main shaft of the top pivot hanger (this will allow it to slide slightly along the top track).
- Loosen the right and left allen head screws at the base of the bottom pivot.
- Place the allen key in the middle allen key screw and turn slightly right or left, the "cam" located under the allen screw head will move the door in or out (either closer to the jamb or further away).
- Manually adjust the top pivot hanger to suit the new position of the bottom pivot (usually a parallel gap between the edge of the pivot door and the jamb).
- Lock off both sets of allen head screws (top and bottom).

3. Flapper door has large gap between door edge and jamb.

Follow procedure for 2 above, but increase the gap between the edge of the pivot door and the jamb.

4. Gap between opposing doors to big or small.

Follow procedure for 2 or 3 above.

5. Flush bolts do not enter striker easily.

Adjust the door as for either 2 or 3 above.

